

Installation instructions and breakage finding

Installation of Safety Cable

AM ROBOTS 3,8mm Premium Safety Cable

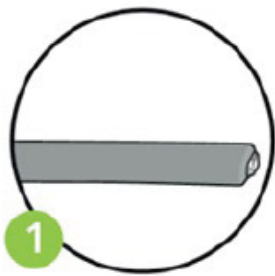

Remove outer layer of plastic isolation.

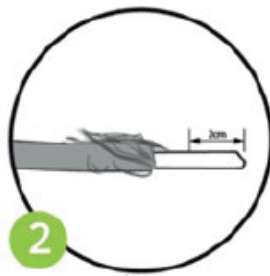

Pull back metal net.

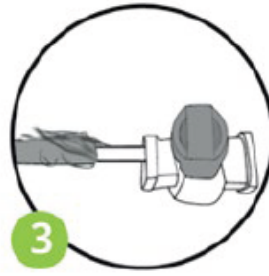

Now you can use any Scotchlock connector.

It is important to make sure that the metal net is cut back and not inserted into the connector at any point.

We recommend using the AM Pro Tracker Plus to find breaks in all kinds of safety cables.

You can both hear and see the signal going down, making it possible to detect both partial- and full-breakage of the cable.

Trouble shooting if you cannot find the break

First check that the cable has been correctly installed, that the outer layer plastic has been removed and the metal protection pulled back.

If the installation has not been made as per the installation guidance above, it might be the issue in hand.

- Check the connectors - especially the 3M 314 connector is often at fault.
- Use the professional tracker from AM ROBOTS called AM Pro Tracker – Plus. This will help detect small breaks in the installation. It can detect both partial and full breakage of the boundary wire.
- Write directly to our support at Info@am-robots.com. And we will try to assist you finding the breaks if needed.

Mounting the AM Pro Tracker Plus

1. Detach the cable from the charging station.
2. Attach the red transmitter wire to the Perimeter Wire.
3. Push the earth rod into the ground and connect it with the black wire from the transmitter.

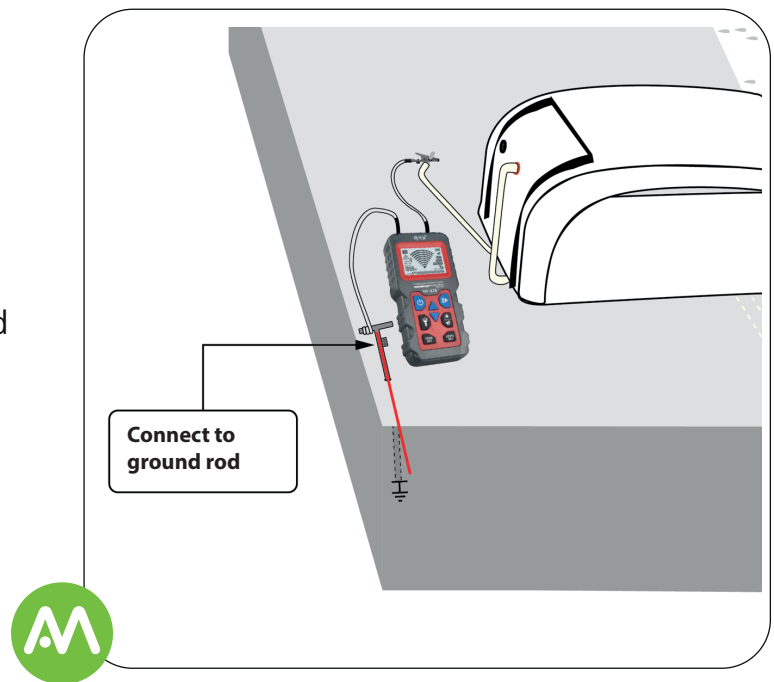

Cable break search

The screen tells you where the cable is, you follow the sound and graphic signal on the receiver screen to locate the break.

1. Walk along the Perimeter Wire until the signal or sound begins to drop.
2. Get closer to the ground to detect precisely where the break is.
3. Dig up the cable, and you will see that the break is visible within 10-15 cm of where you estimated the break to be.

